

LL130 SERIES

Long life photocontrol



SMART wireless terminal controller

The GW-130 dimming controllers feature a user friendly smart phone app with wireless Bluetooth Mesh V5.0 networking to manage you lighting systems. The controllers utilize Bluetooth Smart V5.0 communications standards to provide a flexible network with long distances of up to 600 ft between nodes. Easily assign infinite numbers of fixtures to multiple groups with custom dimming and ON/OFF times to maximize your energy consumption and fixture life.



APPLICATIONS

- LED luminaires that require dimming dusk-to-dawn control
- Recommended for LED luminaires

FEATURES

- Designed to provide long life, enhanced light sensitivity and superior surge protection when used with LED luminaires
- 10 year warranty
- 0-10V dimming
- Anti-UV impact resistant polypropylene cover
- Filtered Silicon Light Sensor - sensitive to sunlight but not LED
- Sealed relay
- IP67
- 2 or 4 MOVs rated for 860J+ or 1720J/10,000 amps each. 430J each.
- Base gasket has a continuous use temperature of 105 C. Melt 185 C.
- 2-5 second turn-off delay
- Heavy .105 inch thick wall thickness

REGULATORY LISTINGS

- Meets ANSI C136.10 and UL 773
- ROHS compliant
- FCC Certificate: X8WBT84X
- UL8750, EN61347-1, Class 2, UL60950-1
- Manufactured in an ISO certified facility
- Surge-rated to ANSI C136.10 Extreme surge level (20Kv, 10Ka, 10 Pulses)
- Zero-Cross detection

OPERATING CHARACTERISTICS

- Voltage 85 to 305 VAC, 60Hz
- Load rating: 1800VA driver
- Up to 120 amp inrush. Test as specified in ANSI C136.10.
- Dimming: PWM - 10V/1kHz; 0-10V standard
- -40°C to +70°C ambient temperature
- ANSI Standard 1.5±0.3 fc Turn ON, Turn OFF is 1.5 times the Turn ON level. Other options available
- 2-5 second Turn OFF delay
- Switch: > 81,000 On/Off operations at rated load
- Dielectric, 5000VAC

DIMENSIONS

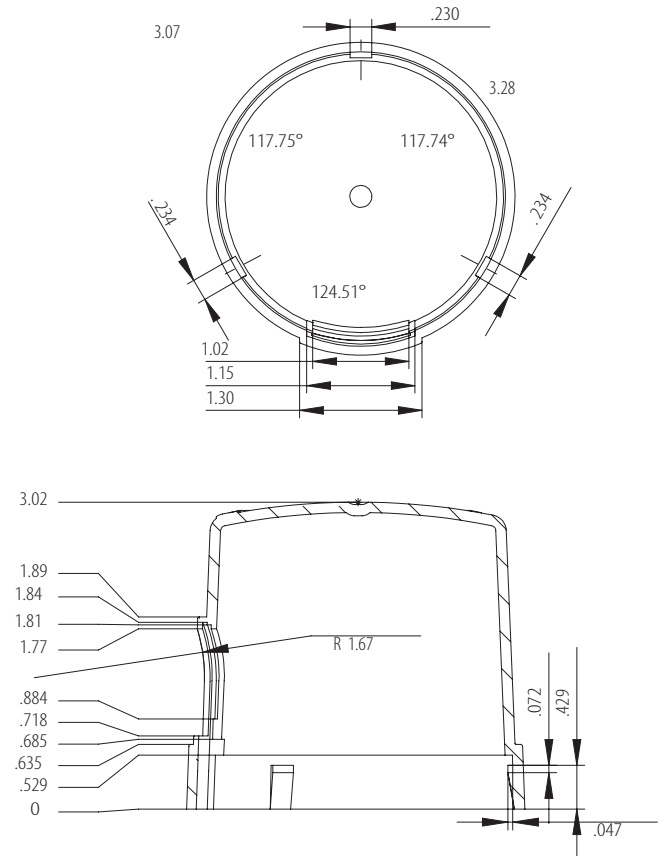

ORDERING INFORMATION

PART NUMBER
GW-LL130